

SR10650

Schottky Barrier Diode

Reverse Voltage - 650 V

Forward Current - 10 A

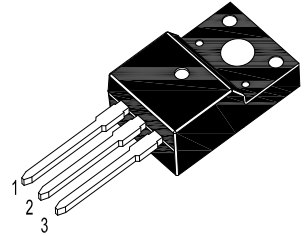

1.GND 2. Anode 3.Cathode
TO-220F Plastic Package

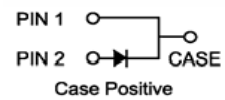

Maximum Ratings and Electrical Characteristics

Ratings at 25°C ambient temperature unless otherwise specified. Single phase, half wave, 60 Hz, resistive or inductive load, for capacitive load, derate by 20%.

Parameter	Symbols	Value	Unit
Maximum Recurrent Peak Reverse Voltage	V_{RRM}	650	V
Maximum Repetitive Reverse Voltage	V_{RM}	600	V
Maximum Average Forward Current	$I_{F(AV)}$	10	A
Peak Forward Surge Current 10 ms Single Half Sine-wave Superimposed on Rated Load (JEDEC Method)	I_{FSM}	40	A
Forward Voltage at $I_F = 10$ A	V_F	1.75	V
Reverse Current at Rated DC Blocking Voltage at $V_R = 600$ V	I_R	200	μA
Thermal Resistance Junction to Lead	$R_{\theta JL}$	2.5	$^{\circ}C/W$
Operating Junction and Storage Temperature Range	T_j, T_{stg}	- 40 to + 175	$^{\circ}C$

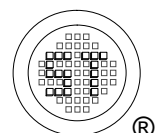

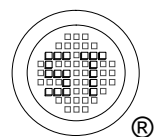
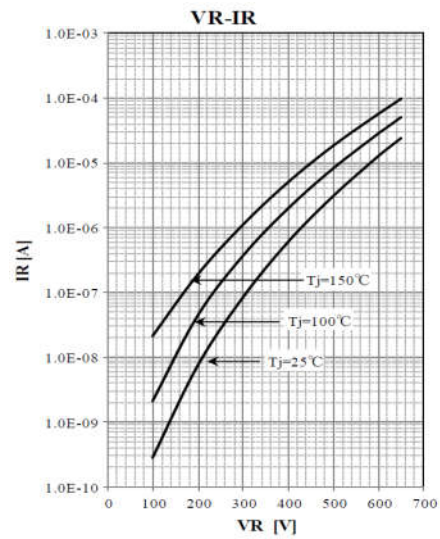
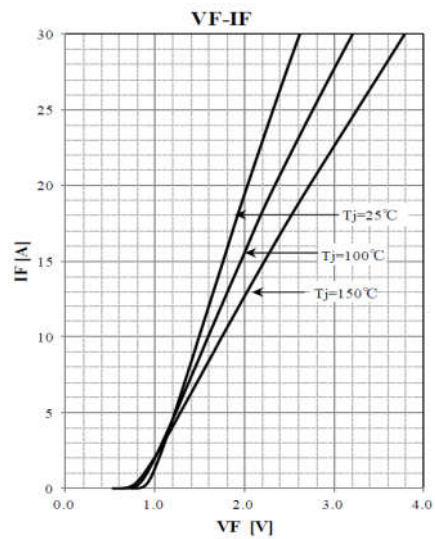

Package Outline Dimensions (Units: mm)

TO-220F

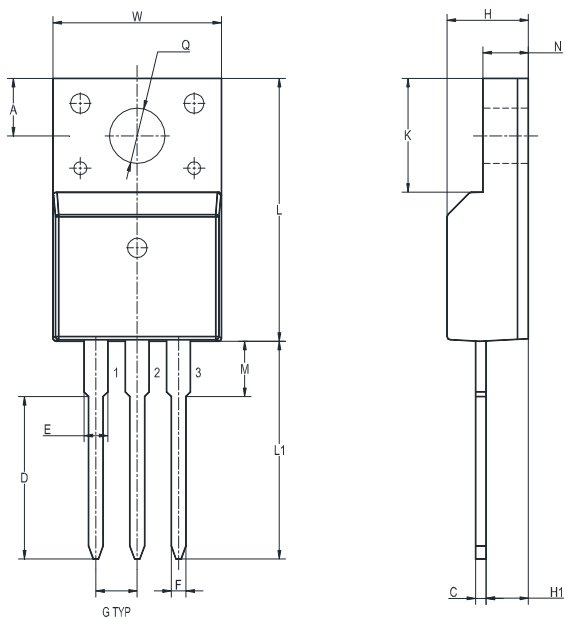

UNIT	A	C	D	E	F	G	W	H	H1	Q	L	L1	M	K	N
mm	3.5	0.7	10.3	1.5	0.9	2.54	10.5	4.9	2.9	3.4	16	13.5	3.5	6.7	2.8
	2.8	0.4	9.7	1.1	0.7	TYP.	9.5	4.5	2.5	2.9	15	12.5	2.9	6.2	2.3

Marking information

" SR10650 " = Part No.
" ***** " = Date Code Marking
Font type: Arial

